

**Part Number: DM-50W-D**  
**7/16 DIN Male**  
**50W Terminator 'Dummy Load'**

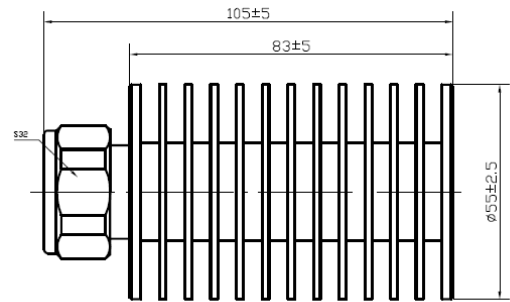

### 1. Electrical Performance

Parameter	Value
Article No.	ESTFZ-003-G-0009-D/A
Frequency range	DC to 3GHz
Impedance	50±1.5Ω
VSWR	≤1.25
Withstanding Voltage	2700V
Rated Power	50W
Connector Type	7/16 (DIN)-Male
Standard	IEC60169-4

### 2. Mechanical Performance

Parameter	Value
Waterproof degree	IP65
Moisture resistance	IP65
Mating cycles	≥500
Outer Dimension	Φ 105mm × 55mm

### 3. Environment Performance

Parameter	Value
Operating temperature range	-40°C~+125°C
Storage temperature range	-30°C~+45°C

### 4. Material &Plating

Connector parts	Material	Plating
Center conductor	Brass	Silver
Outer conductor	Brass	CuSnZn
Dielectric	PTFE	/
Radiator	Aluminum	/

### 5. Packing

Standard	1 pc/plastic bag in separate carton
----------	-------------------------------------

Remark: Dimensions are in mm with tolerance of ±2%.